

# RollOn

## Instructions for Use

English

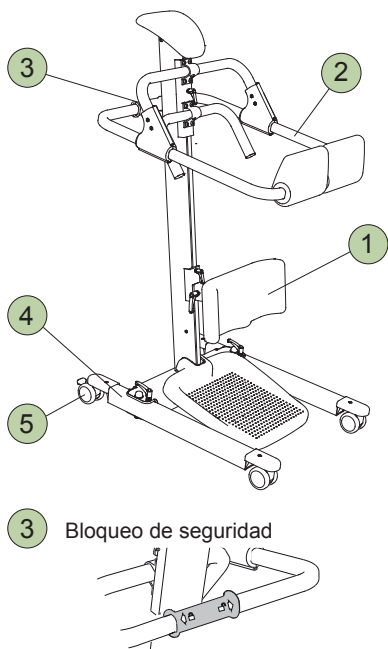

3 Bloqueo de seguridad

### Safety Instructions

- Read the instructions before use.
- Ensure that the proper adjustments have been made and that the patient is able to stand securely in the raising support before the transfer takes place.
- Ensure that all locking handles are properly secured before transfer takes place.
- As a caregiver you are responsible for the patient's safety. You must be well informed of the patient's condition and ability to manage the transfer situation with RollOn.
- **Max. load: 160 kg (350 lbs.)**

Never leave a patient unattended during a transfer situation.

### IMPORTANT!

These instructions for use do not replace RollOn's instruction guide, which can be downloaded from [www.liko.com](http://www.liko.com).

### 1 Lower-leg Support

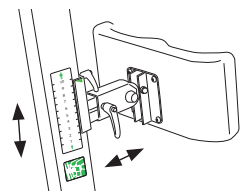

**Adjustment**  
The height and depth of the lower-leg support are adjustable.

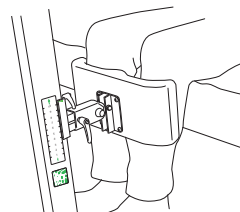

**Try-out**  
Adjust the height of the lower-leg support so that it provides comfortable counter pressure just beneath the patient's kneecaps. If needed, the lower-leg support can also be vertically adjusted.

### 2 Seat Frame

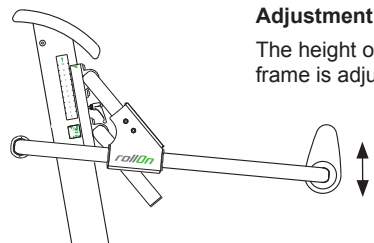

**Adjustment**  
The height of the seat frame is adjustable.

### Try-out

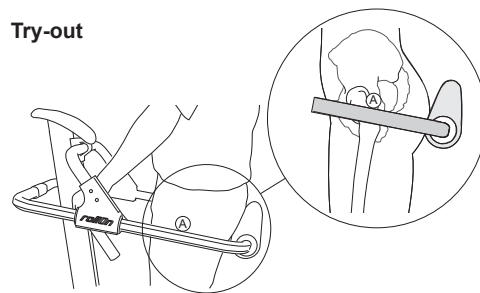

To prevent the patient from sitting on the rear supports and to prevent him/her from sliding down and out of the support, the frame should be set just under the patient's hip joints (A).

### 3 Safety Lock

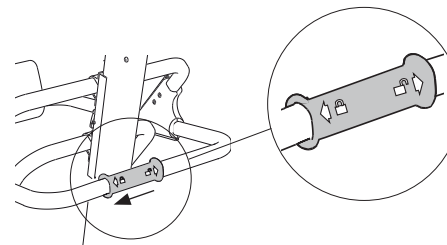

**⚠ The safety lock should be in the locked position during transfer.**

### 4 Base

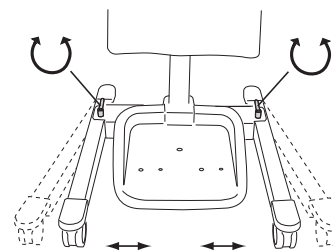

### 5 Locking the Wheels

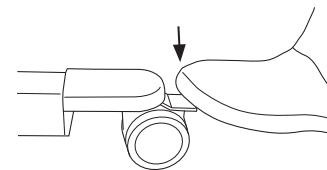

**⚠ Lock the wheels during raising.**

### Areas of Use:

- to/from bed and chair/wheelchair
- to/from chair/wheelchair and toilet
- repositioning in a chair/wheelchair.

The RollOn bridges the gap between conventional walkers and powered sit-to-stand lifts.

### Problems during Use

If the patient does not achieve a sufficiently upright position, we recommend a lift from Liko's product range; the first choice being the sit-to-stand lift Sabina.

### Ergonomics

- Do not lift manually. Let the patient and RollOn do the job.
- Take it easy. Work calmly and methodically
- Don't strain your back. Work in a walking-stance with your back straight
- Don't twist your back. Move your feet
- Reduce the lever effect. Work close to the patient and the support.

### Cleaning

When necessary, clean the RollOn with common surface cleaners or disinfectants and check to ensure that the wheels are free of dirt and hair.

### Other Instructions for Use

Liko's instructions for use are available for downloading at [www.liko.com](http://www.liko.com).

© Copyright Liko AB



A Hill-Rom Company

[www.liko.com](http://www.liko.com)

Manufacturer:

Liko AB  
SE-975 92 Luleå  
Sweden  
[info@liko.se](mailto:info@liko.se)

7EN175501-01